

Apr.1.2017 Copyright 2017 HIROSE ELECTRIC CO., LTD. All Rights Reserved.

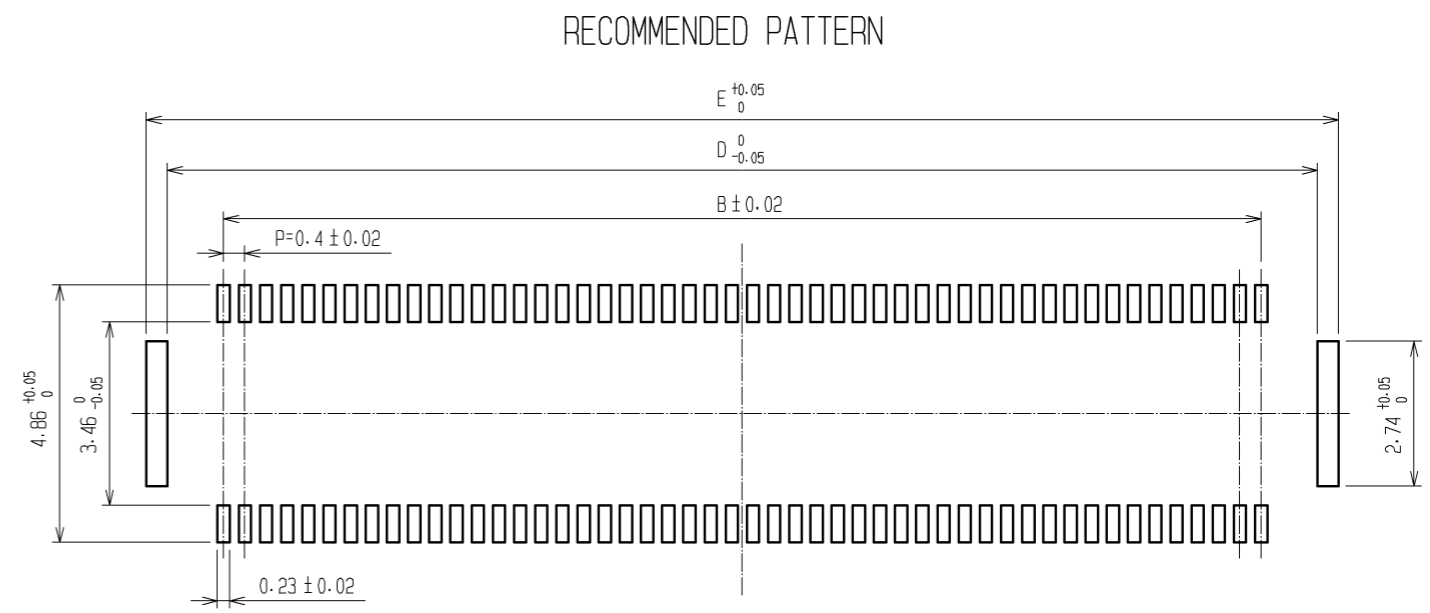

RECOMMENDED SOLDER PASTE: THICKNESS 120#m

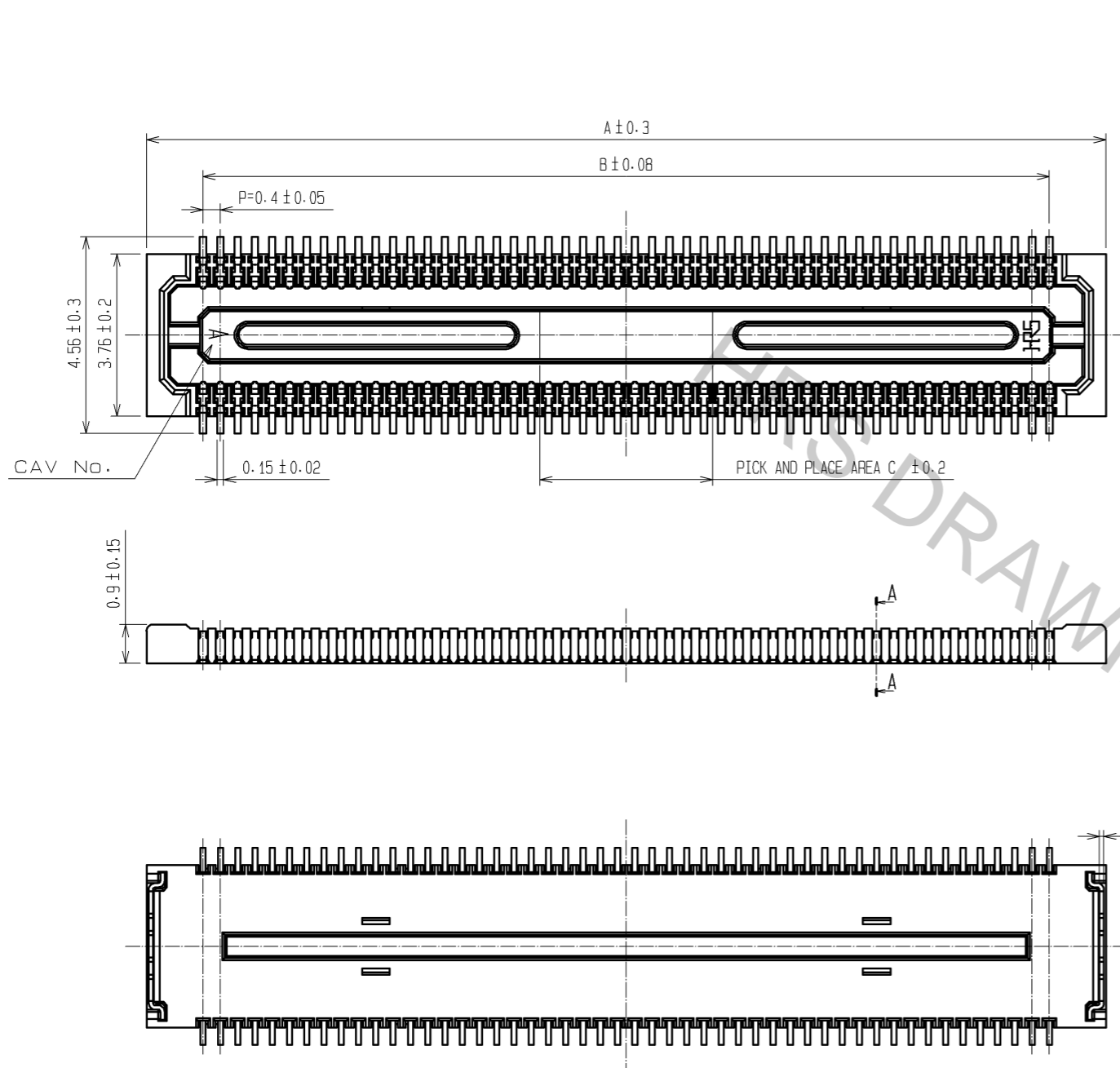
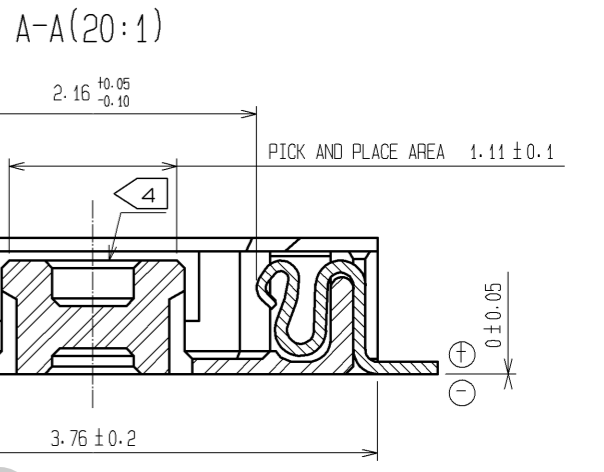
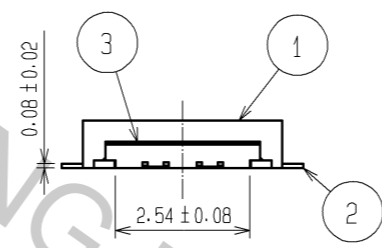

- NOTE 1. ALL LEADS CO-PLANARITY SHALL BE 0.1 MAX.
 2. PER REEL : 1000 CONNECTORS.
 3. AT THE BEGINNING OF THE REEL, 100 mm AT MIN SHALL BE EMPTY POCKETS.
 AT THE END OF THE REEL, 160 mm AT MIN SHALL BE EMPTY.
 4 NO CAVITY ON THE CONNECTORS LESS THAN 24 POS.
 5 CONTACT PLATING SPECIFICATIONS.
 CONTACT AREA : GOLD 0.05#m MIN.
 SMT LEAD : GOLD 0.02#m MIN.
 UNDERPLATING : NICKEL 1#m MIN.
 (SURFACE : SEALING)
 6 METAL HOLD DOWN PLATING SPECIFICATIONS.
 MOUNTING AREA: TIN 1#m MIN.
 UNDERPLATING : NICKEL 1#m MIN.
 7. PEEL FORCE REFERS TO JIS C 0806.

| PART NO. | A | B | C | D | E |
|-----------------------|-------|------|------|-------|-------|
| DF30FB- 80DS-0.4V(82) | 18.22 | 15.6 | 3.2 | 17.72 | 18.52 |
| DF30FB- 70DS-0.4V(82) | 16.22 | 13.6 | 2.8 | 15.72 | 16.52 |
| DF30FB- 60DS-0.4V(82) | 14.22 | 11.6 | 2.4 | 13.72 | 14.52 |
| DF30FB- 50DS-0.4V(82) | 12.22 | 9.6 | 2 | 11.72 | 12.52 |
| DF30FB- 40DS-0.4V(82) | 10.22 | 7.6 | 1.6 | 9.72 | 10.52 |
| DF30FB- 34DS-0.4V(82) | 9.02 | 6.4 | 1.36 | 8.52 | 9.32 |
| DF30FB- 30DS-0.4V(82) | 8.22 | 5.6 | 1.2 | 7.72 | 8.52 |
| DF30FB- 24DS-0.4V(82) | 7.02 | 4.4 | 1.2 | 6.52 | 7.32 |
| DF30FB- 22DS-0.4V(82) | 6.62 | 4.0 | 1.2 | 6.12 | 6.92 |
| DF30FB- 20DS-0.4V(82) | 6.22 | 3.6 | 1.2 | 5.72 | 6.52 |

| NO. | MATERIAL | FINISH | REMARKS | NO. | MATERIAL | FINISH | REMARKS |
|-----|-----------------|--------|----------------|-----|-----------|--------|-------------------------------|
| 3 | PHOSPHOR BRONZE | 6 | | 6 | PS | | PLASTIC REEL (BLACK) |
| 2 | PHOSPHOR BRONZE | 5 | | 5 | POLYESTER | | CLEAR (COVER TAPE) |
| 1 | LCP | | UL94V-0, BLACK | 4 | PS | | CLEAR (EMBOSSED CARRIER TAPE) |

| UNITS | SCALE | COUNT | DESCRIPTION OF REVISIONS | DESIGNED | CHECKED | DATE |
|-------|-------|-------|--------------------------|------------|---------------|----------|
| mm | FREE | 2 | DIS-H-005343 | TK. SUZUKI | AR. TAKAHASHI | 10.11.30 |

| APPROVED | DATE | DRAWING NO. |
|---------------|----------|----------------------|
| MO. NAKAMURA | 05.09.30 | EDC3-303547-04 |
| CHECKED | 05.09.29 | PART NO. |
| AR. TAKAHASHI | 05.09.29 | DF30FB- *DS-0.4V(82) |
| DESIGNED | 05.09.29 | CODE NO. |
| AR. TAKAHASHI | 05.09.29 | CL684- |

