

THIS DRAWING IS UNPUBLISHED.

RELEASED FOR PUBLICATION

ALL RIGHTS RESERVED.

© COPYRIGHT - By -

LOC

DIST

REVISIONS

HB

P

LTR

DESCRIPTION

DATE

DWN

APVD

D

CHANGE LOGO,VENT,ADD LINE IDENTIFIER,CCC,PLATING THICKNESS ECO-12-005725

21-AUG-12

D.L

BH.Y

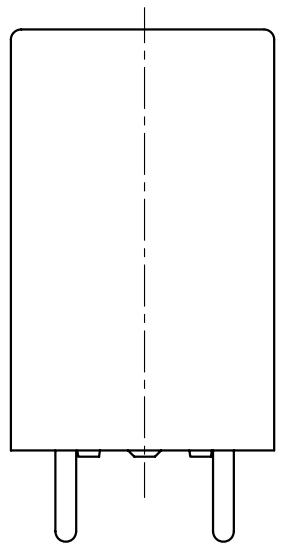
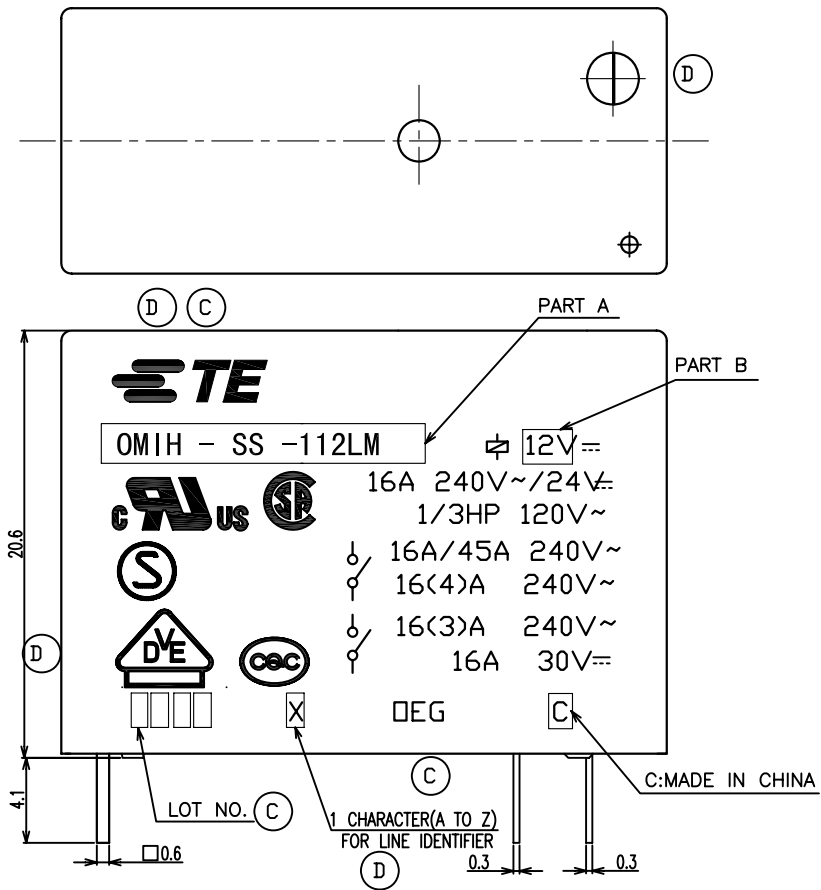

CONNECTION DIAGRAM (BOTTOM VIEW)



DRILLING DIAGRAM(2/1) (BOTTOM VIEW)

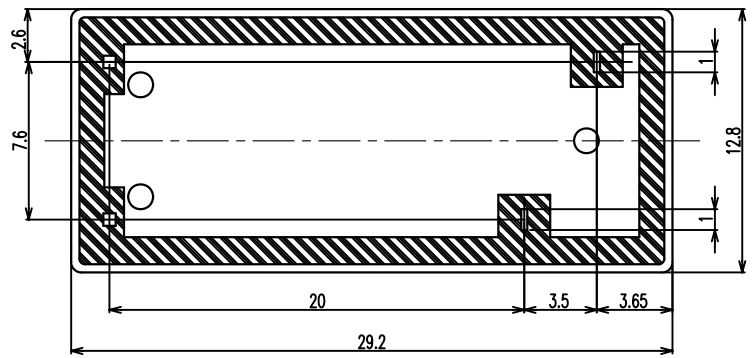
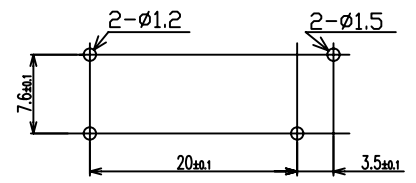

| | | | | |
|--|--|-------------------|-----------------------------------|--------------------|
| THIS DRAWING IS A CONTROLLED DOCUMENT. | | DWN Y.Xiao | TE Connectivity | |
| | | CHK N.Funayama | | |
| | | APVD CH.HSU | NAME | |
| | | PRODUCT SPEC | OMIH(1M) SPEC300 CUSTOMER DRAWING | |
| | | APPLICATION SPEC | | |
| | | WEIGHT | SIZE A3 | CAGE CODE 00779 |
| | | | DRAWING NO C=2-1419153-1 | RESTRICTED TO |
| | | CUSTOMER DRAWING | SCALE 4:1 | SHEET 1 of 2 |
| | | | | REV D |

THIS DRAWING IS UNPUBLISHED.

RELEASED FOR PUBLICATION

ALL RIGHTS RESERVED.

© COPYRIGHT - By -

| LOC | DIST | REVISIONS | | | | | |
|-----|------|-----------|-----|-------------|------|-----|------|
| HB | - | P | LTR | DESCRIPTION | DATE | DWN | APVD |
| | | | | | | | |

NOTES:
① LOT NO. SYSTEM AS FOLLOWING:

0 8 2 5
 WEEK
 YEAR

② GENERAL TOLERANCE AS FOLLOWING:

| TOLERANCE | |
|------------|------|
| 0~0.99mm | ±0.1 |
| 1mm~2.99mm | ±0.2 |
| 3mm~MIN. | ±0.3 |

③ ④ TERMINAL DIMENSION IS NOT INCLUDING SOLDER TIP.
 FOR THE TIN-PLATING OF THE PINS:
 +0.1mm FOR WIDTH, THICKNESS AND DIAMETER.
 +0.5mm FOR LENGTH.

| | | | |
|---------------|-------------|---------------|--------|
| OMIH-SH-124DM | 7-1440000-3 | OMIH-SH-124DM | 24V |
| OMIH-SH-112LM | 1461009-1 | OMIH-SH-112LM | 12V |
| OMIH-SH-112DM | 1461022-1 | OMIH-SH-112DM | 12V |
| OMIH-SS-106DM | 1461022-9 | OMIH-SS-106DM | 6V |
| OMIH-SS-105DM | 1461022-5 | OMIH-SS-105DM | 5V |
| OMIH-SS-148LM | 9-1419121-2 | OMIH-SS-148LM | 48V |
| OMIH-SS-148LM | 2-1419145-2 | OMIH-SS-148LM | 48V |
| OMIH-SS-148LM | 9-1440000-4 | OMIH-SS-148LM | 48V |
| OMIH-SS-148DM | 9-1440000-2 | OMIH-SS-148DM | 48V |
| OMIH-SS-124LM | 2-1419153-2 | OMIH-SS-124LM | 24V |
| OMIH-SS-124DM | 8-1440000-9 | OMIH-SS-124DM | 24V |
| OMIH-SS-118DM | 8-1440000-7 | OMIH-SS-118DM | 18V |
| OMIH-SS-112LM | 8-1440000-6 | OMIH-SS-112LM | 12V |
| OMIH-SS-112DM | 8-1440000-4 | OMIH-SS-112DM | 12V |
| OMIH-SS-109LM | 8-1440000-2 | OMIH-SS-109LM | 9V |
| OMIH-SS-109DM | 8-1440000-0 | OMIH-SS-109DM | 9V |
| OMIH-SS-106LM | 7-1440000-9 | OMIH-SS-106LM | 6V |
| OMIH-SS-105LM | 2-1419153-1 | OMIH-SS-105LM | 5V |
| EC TYPE NAME | PART NO | PART A | PART B |

RELAY TYPE

| | | | | |
|------------------|------------|-------------|---------------------|------|
| | | UV RESIN | UV SEAL | 16 |
| | | EPOXY RESIN | SEAL | 15 |
| UL94 V-0 | | PBT | CASE | 14 |
| CLASS E | | UEW | MAGNETIC WIRE | 13 |
| UL94 V-0 | | PET | BASE | 12 |
| UL94 V-0 | | PBT | BOBBIN | 11 |
| | SOLDER DIP | CP WIRE | COIL TERMINAL | 10 |
| UL94 V-0 | | PPS | CARD | 9 |
| | | Ag ALLOY | MOVABLE CONTACT | 8 |
| | | Ag ALLOY | STATIONARY CONTACT | 7 |
| | | Cu ALLOY | HINGE SPRING | 6 |
| | SOLDER DIP | Cu ALLOY | STATIONARY TERMINAL | 5 |
| | SOLDER DIP | Cu ALLOY | MOVABLE SPRING | 4 |
| | | STEEL | CORE | 3 |
| | | STEEL | ARMATURE | 2 |
| | | STEEL | YOKE | 1 |
| INCOMBUSTIBILITY | TREATMENT | MATERIAL | DESCRIPTION | ITEM |

| | | | | |
|--|--------|------------------|---|--|
| THIS DRAWING IS A CONTROLLED DOCUMENT. | | DWN Y.Xiao | TE Connectivity | |
| DIMENSIONS: mm | | CHK N.Funayama | NAME | |
| TOLERANCES UNLESS OTHERWISE SPECIFIED: | | APVD CH.HSU | OMIH(1M) SPEC300 CUSTOMER DRAWING | |
| 0 PLC ± - | | PRODUCT SPEC | SIZE CAGE CODE DRAWING NO RESTRICTED TO | |
| 1 PLC ± - | | APPLICATION SPEC | A3 00779 C=2-1419153-1 | |
| 2 PLC ± - | | WEIGHT | SCALE 4:1 SHEET 2 of 2 REV D | |
| 3 PLC ± - | | | | |
| 4 PLC ± - | | | | |
| ANGLES ± - | | CUSTOMER DRAWING | | |
| MATERIAL | FINISH | | | |